



59 Newland Avenue, Scunthorpe, DN15 7HQ

£160,000

Lovely bay fronted traditional three bed semi that has just been refurbished, close to the Hospital, Newland Avenue is now available to buy with no chain and vacant possession. Extended at the back this home has two reception rooms, a nice size galley kitchen, hall, three beds and bathroom. In recent years the property has had a host of upgrades; main roof in 2021, extension roof in 2023, combination boiler in 2021 and these have made this a perfect home for a young family in our opinion, ready to move straight into. Viewings are available by appointment, please get in touch to book yours.



Entrance Hall



Bedroom Two 11'5" x 11'6" (3.49 x 3.51)



Lounge 11'5" x 11'6" (3.49 x 3.52)



Bedroom Three 7'0" x 6'11" (2.15 x 2.11 )



Dining Room 18'2" x 11'6" (5.56 x 3.52)



Kitchen 15'1" x 6'10" (4.60 x 2.10)



Family Bathroom 6'6" x 6'11" (2.00 x 2.11 )



Landing

Bedroom One 11'5" x 11'6" (3.49 x 3.51)



Outside



Ground Floor

Approx. 53.2 sq. metres (572.5 sq. feet)

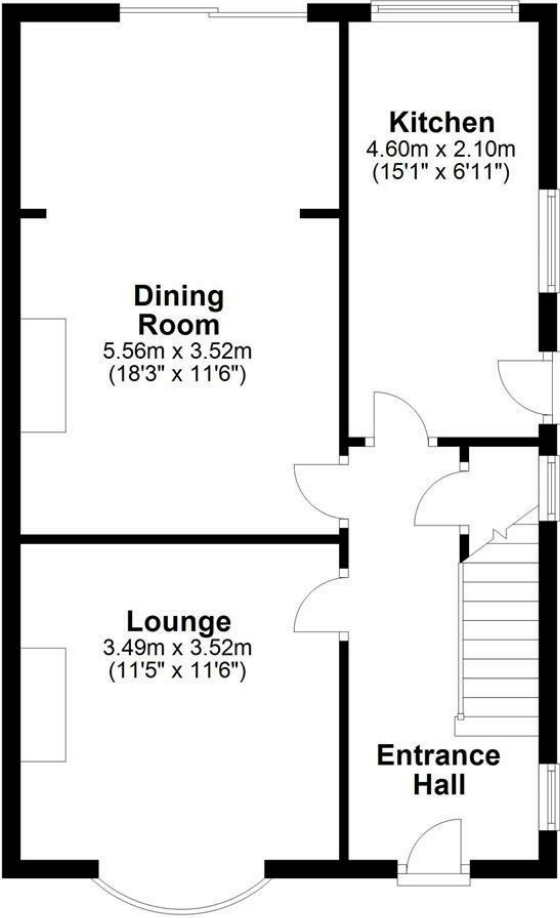

First Floor

Approx. 40.7 sq. metres (438.5 sq. feet)

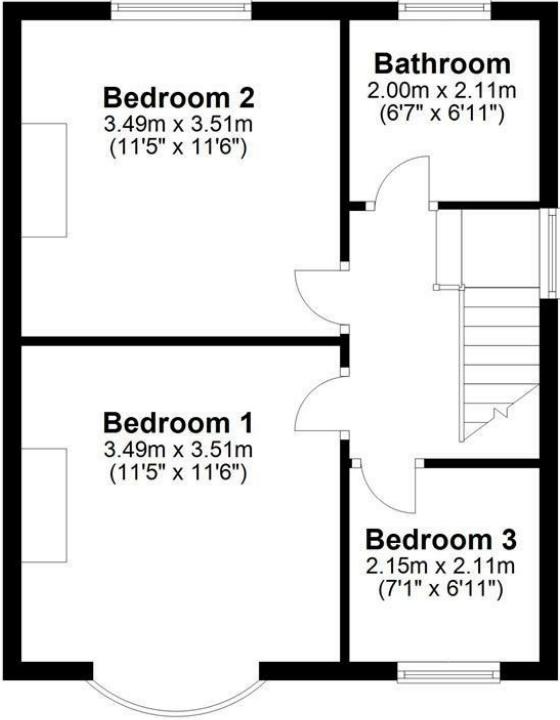

Total area: approx. 93.9 sq. metres (1011.0 sq. feet)

Area Map



Energy Efficiency Graph

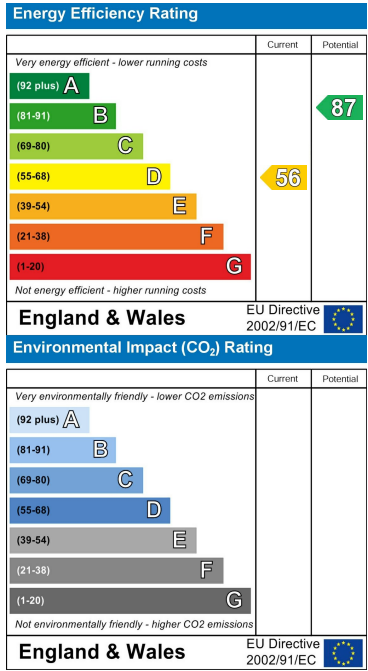

These particulars, whilst believed to be accurate are set out as a general outline only for guidance and do not constitute any part of an offer or contract. Intending purchasers should not rely on them as statements of representation of fact, but must satisfy themselves by inspection or otherwise as to their accuracy. No person in this firm's employment has the authority to make or give any representation or warranty in respect of the property.